

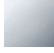











10 125 970

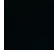

Passt zu: IMO, LULU, MADISON, MEM, TARA, CL.1, LISSÉ, VAIA, META, CYO

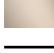
	Champagne (22kt Gold)	10 125 970-47
	Chrom	10 125 970-00
	Platin gebürstet	10 125 970-06
	Platin	10 125 970-08
	Messing (23kt Gold)	10 125 970-09
	Dark Chrome	10 125 970-19
	Light Gold	10 125 970-26
	Light Gold gebürstet	10 125 970-27
	Messing gebürstet (23kt Gold)	10 125 970-28
	Schwarz matt	10 125 970-33
	Platin / Platin gebürstet	10 125 970-36
	Messing / Messing gebürstet (23kt Gold)	10 125 970-38
	Bronze gebürstet	10 125 970-42
	Champagne gebürstet (22kt Gold)	10 125 970-46
	Chrom gebürstet	10 125 970-93
	Dark Platinum gebürstet	10 125 970-99



Ablaufgarnitur mit Druckverschluss 1 1/4" - Champagne (22kt Gold)

IMO

10 125 970

Nur für Becken mit Überlauf geeignet.

10 125 970

mm [inches]

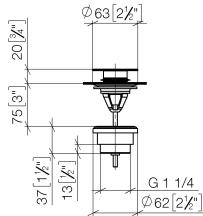

10 125 970

Ersatzteile für die
anderen
Oberflächenvarianten
finden Sie hier:
Chrom

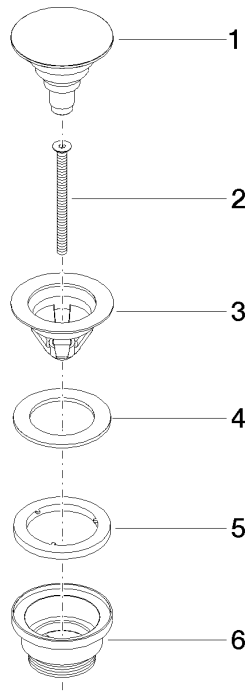

Ersatzteilstückliste

Nr.	Artikelnummer	Benennung	Verbaumenge	Lieferzeit
1	04 31 20 096 00-47	Stopfen	1	-
Ersatzteil nicht mehr bestellbar, bitte bestellen Sie den Nachfolgeartikel				
2	09 30 30 179 90	Schraube	1	2
3	09 11 01 038-47	Kelch	1	60
4	09 14 05 061 90	Dichtung	1	2
5	09 14 03 153 90	Dichtung	1	2
6	09 11 10 156-47	Anschluss	1	60